

PRODUCT CODE: TR 25 X

INOX FLUSH CUTTING EDGE. MEDIUM SERIES.



Flush cutter for cutting of copper wire and other soft materials. MADE BY INOX STEEL.

Cutting edge hardness: 54HRC approx..

Steel thickness 2.5 mm.

Tool is equipped with a return spring designed to have a constant force, thus reducing operator effort.

Also available in ESD-safe version..

Made in Italy with special INOX steel and undergo a controlled atmosphere heat treatment.

The anti-reflection phosphating surface treatment ensures an accurate view of the work being carried out.

The anti-slip bi-material dolphin handle is created following ergonomic principles, thus guaranteeing a safe, light and comfortable grip for the operator.

Laser marked.

Cutting Capacity	Ø 1.3 mm (AWG 16) copper wire
Cutting force	5 kg
Steel thickness	2.5 mm
Blade angle	27°
Length	138 mm
Net weight	75 g
ESD	NO
With safety clip	NOT available
Handle colour	orange/black

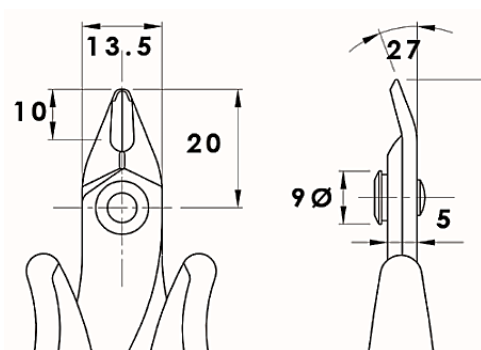

This type of shear cut, with slightly overlapping blades, due to the fact it does not exert mechanical stress, requires less force than that required by ordinary tools and results in reduced operator fatigue. A small measured cutting-edge misalignment is needed for the correct functioning of this tool.